

DAVIMAC CHASER BIN PARTS LIST

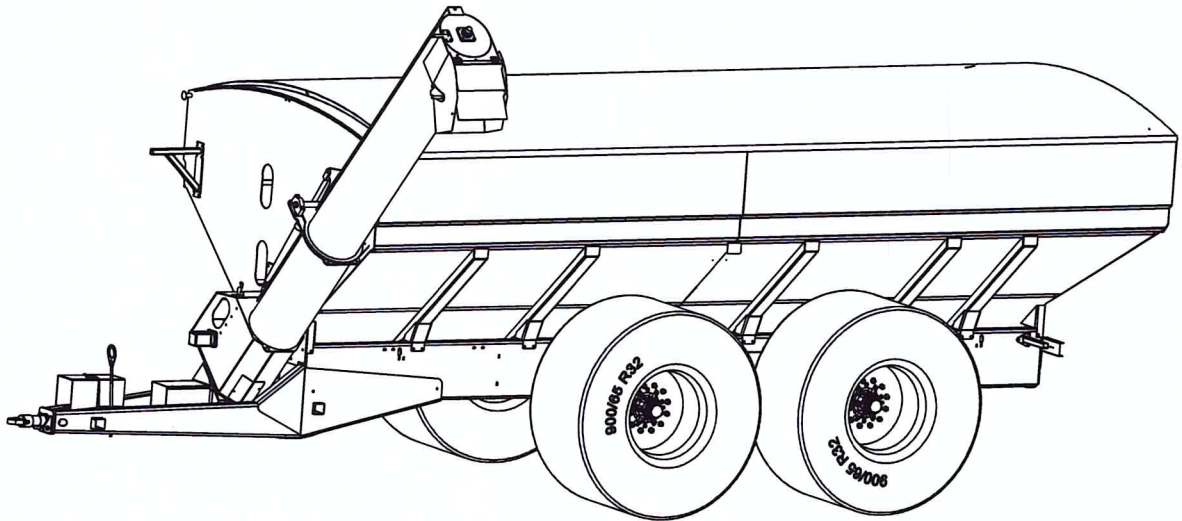
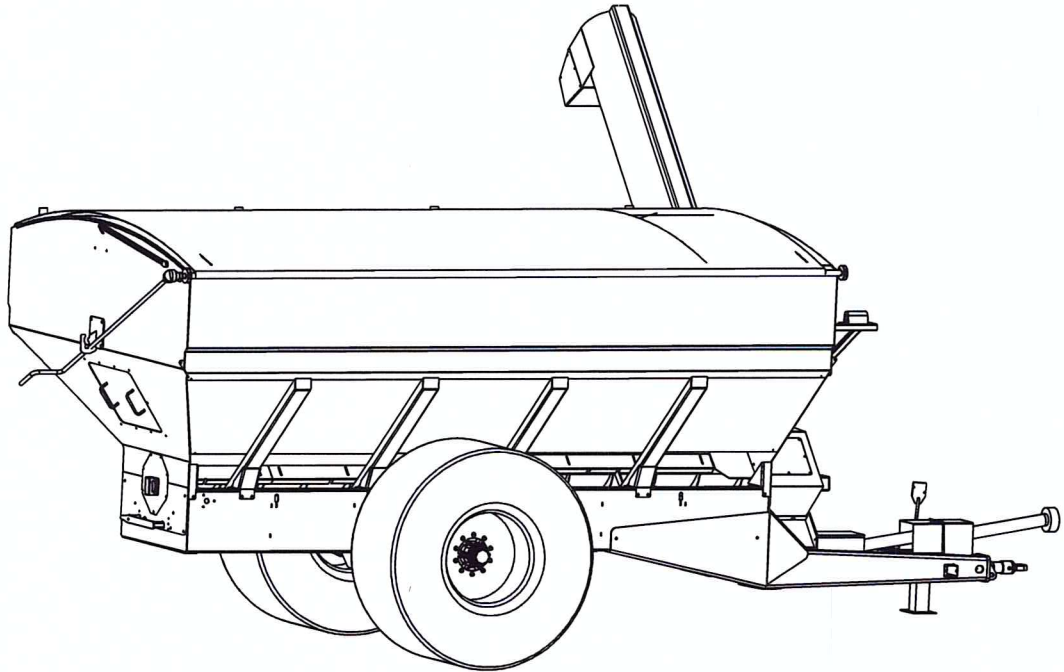

FROM: CB2811
TO: CB6613

DAVIMAC
MANUFACTURING

DAVIMAC PTY LTD
55 WELLINGTON STREET
MOLONG NSW

STANDARD CHASER BIN - FRONT

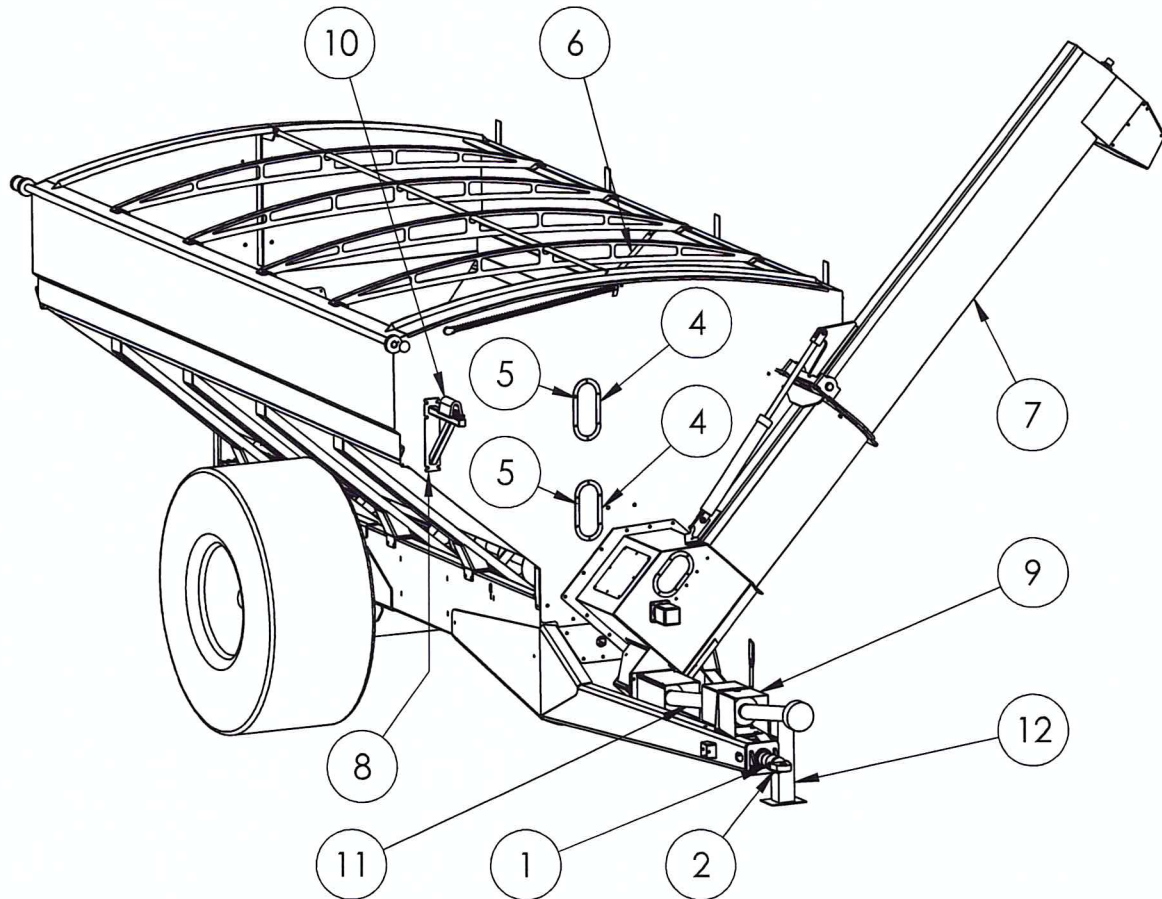

ITEM NO.	PART NUMBER	DESCRIPTION	QTY.	PAGE
1	0202009-01 25001	STANDARD TOW SWIVEL LOAD CELL TOW SWIVEL	1	-
2	0202009-06	TOW HITCH	1	-
4	0205011	WINDOW SURROUND	4	-
5	0205012	WINDOW	2	-
6	0205013	STAY ROD	2	-
7	-	AUGER ASSEMBLY	1	3
8	0207009	AUGER CATCH BRACKET	1	-
9	-	PTO COUPLING ASSEMBLY	1	8
10	0220014	AUGER CATCH RUBBER	1	-
11	0220022	REAR PTO SHAFT	1	-
12	0220033	JACK STAND - B9696	1	-

Issue:

STANDARD CHASER BIN - REAR

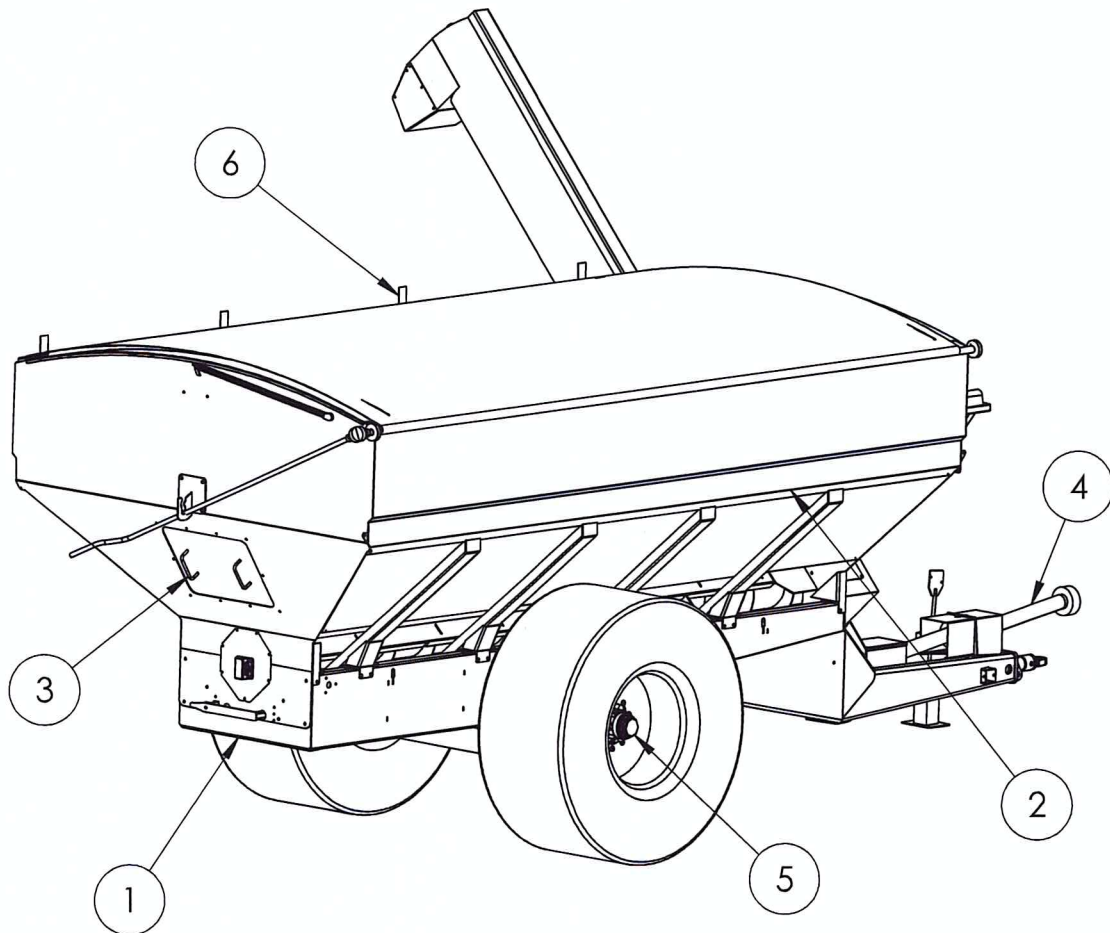

ITEM NO.	PART NUMBER	DESCRIPTION	QTY.	PAGE
1	0202001	CHASSIS	1	-
2	0205001	BIN	1	-
3	0205037	MAN HOLE	1	-
4	0220031	FRONT PTO SHAFT	1	-
5	-	AXLE ASSEMBLY	1	8/9
6	-	TARP ASSEMBLY	4	10

Issue:

AUGER ASSEMBLY

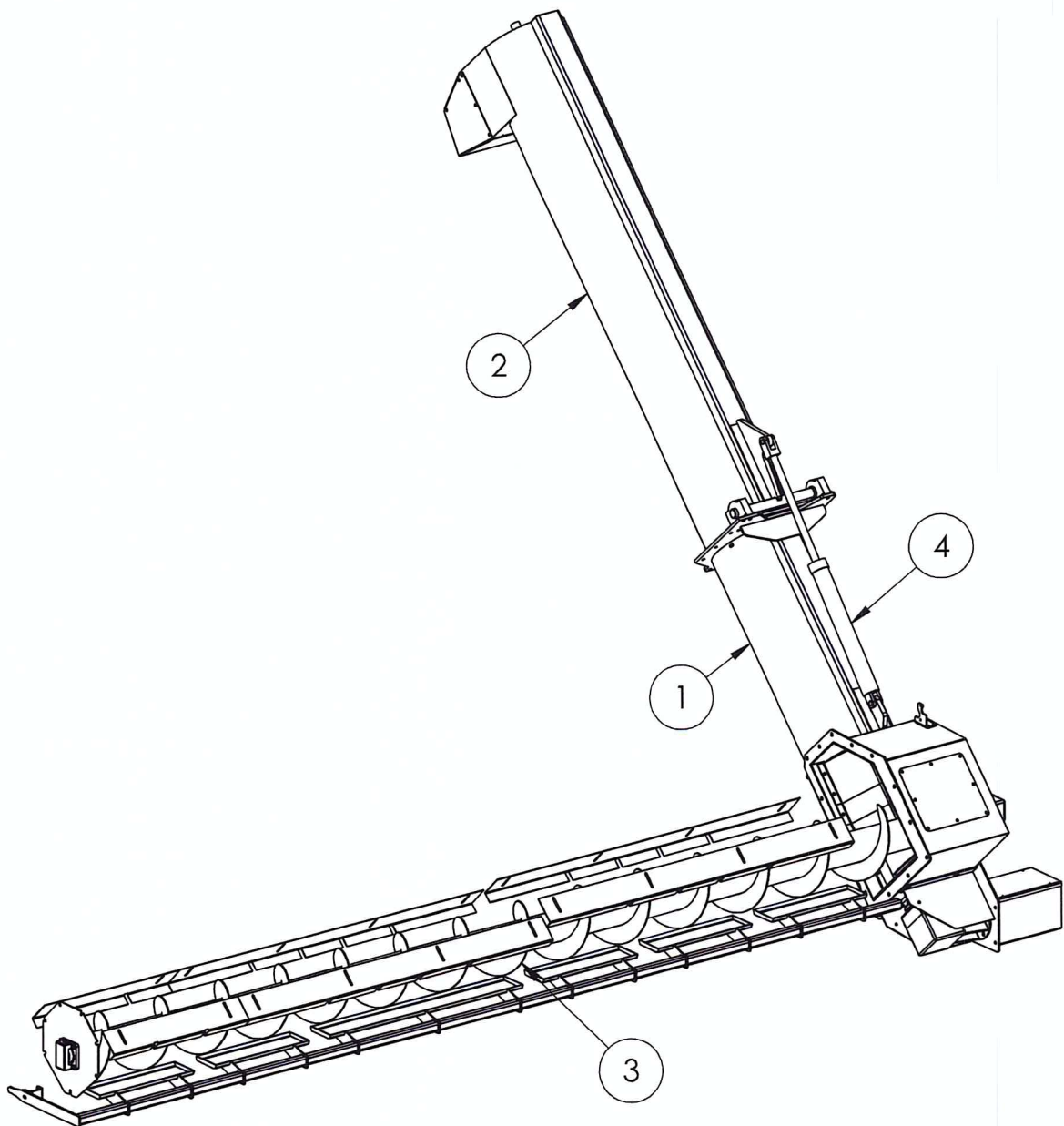

ITEM NO.	PART NUMBER	DESCRIPTION	QTY.	PAGE
1	-	LOWER AUGER ASSEMBLY	1	4
2	-	UPPER AUGER ASSEMBLY	1	5
3	-	CROSS AUGER	1	6/7
4	2101003	HYDRAULIC CYLINDER	1	-

Issue:

LOWER AUGER ASSEMBLY

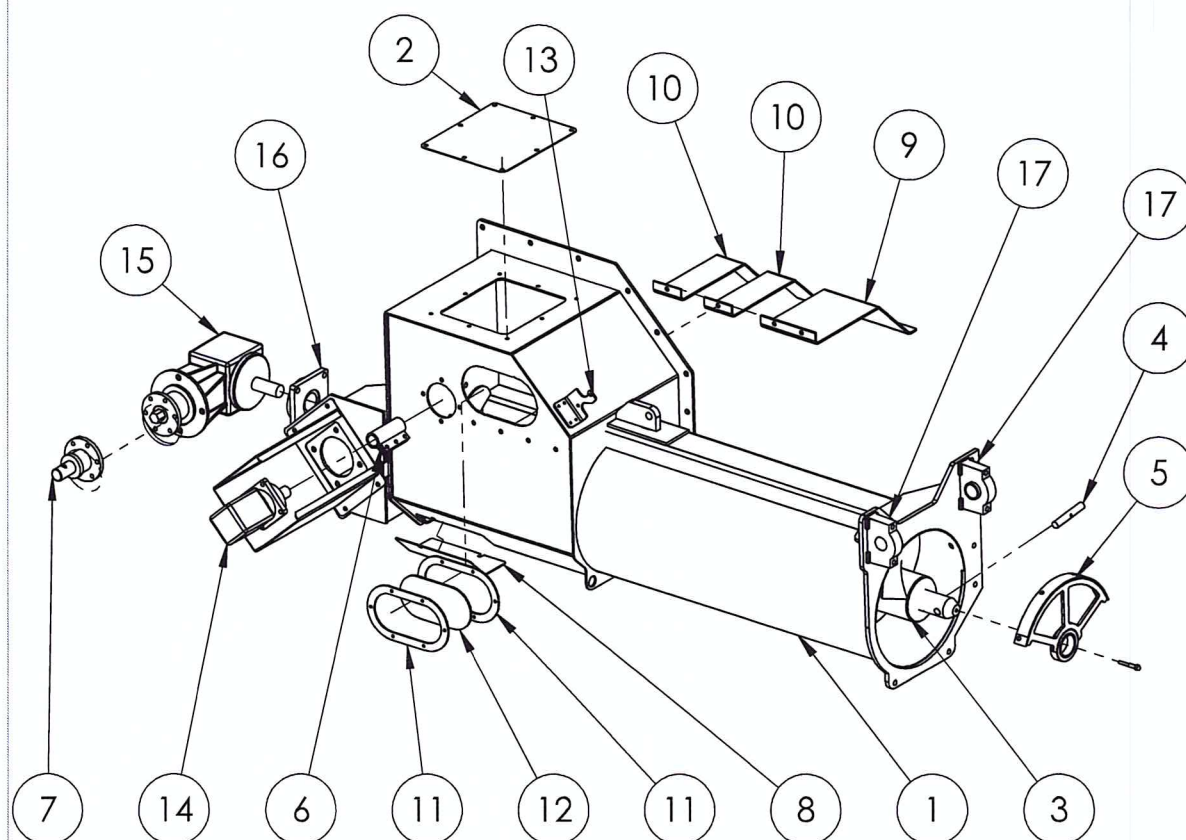

ITEM NO.	PART NUMBER	DESCRIPTION	QTY.
1	0207030 0207001	LOWER AUGER BODY - 15" LOWER AUGER BODY - 20"	1
2	0207002-10	TOP AUGER ACCESS HATCH	1
3	0207032 0207003	LOWER AUGER SHAFT - 15" LOWER AUGER SHAFT - 20"	1
4	0207003-10	AUGER DRIVE PIN	1
5	0207005	TOP BEARING ASSEMBLY	1
6	0207007	CROSS AUGER COUPLING	1
7	0207015	PTO FLANGE	1
8	0207024-01	BOTTOM AUGER ACCESS HATCH	1
9	0207048	WIDE AUGER CUTOFF PLATE	1
10	0207049	NARROW AUGER CUTOFF PLATE	2
11	0207058	AUGER WINDOW FRAME	2
12	0207059	AUGER WINDOW	1
13	0220004	VALVE BRACKET	1
14	2102002	HYDRAULIC MOTOR - HT 315	1
15	2410001	AUGER GEARBOX	1
16	2601003	BEARING	1
17	2602001	AUGER FOLD BEARING	2

Issue:

UPPER AUGER ASSEMBLY

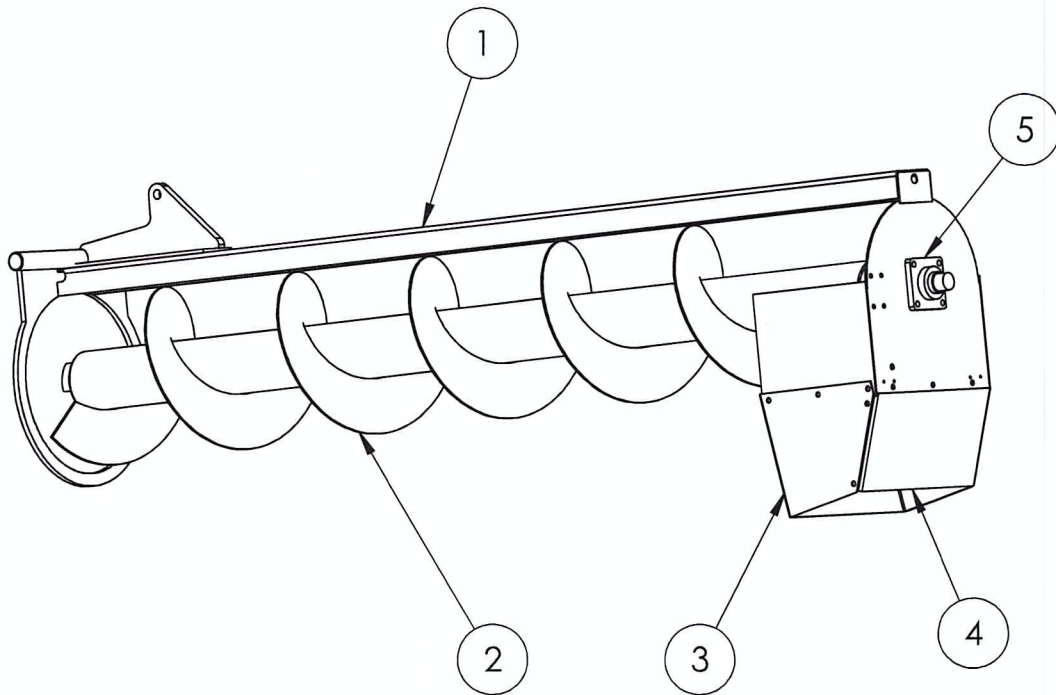

ITEM NO.	PART NUMBER	DESCRIPTION	QTY.
1	0207031 0207002	15" UPPER AUGER BODY 20" UPPER AUGER BODY	1
2	0207033 0207004	15" UPPER AUGER 20" UPPER AUGER	1
3	0207036 0207027	15" AUGER SPOUT 20" AUGER SPOUT	1
4	0207037 0207028	15" AUGER DEFLECTOR 20" AUGER DEFLECTOR	1
5	2601002	BEARING – UCF210	1

Issue:

18T & 25T CROSS AUGER ASSEMBLY

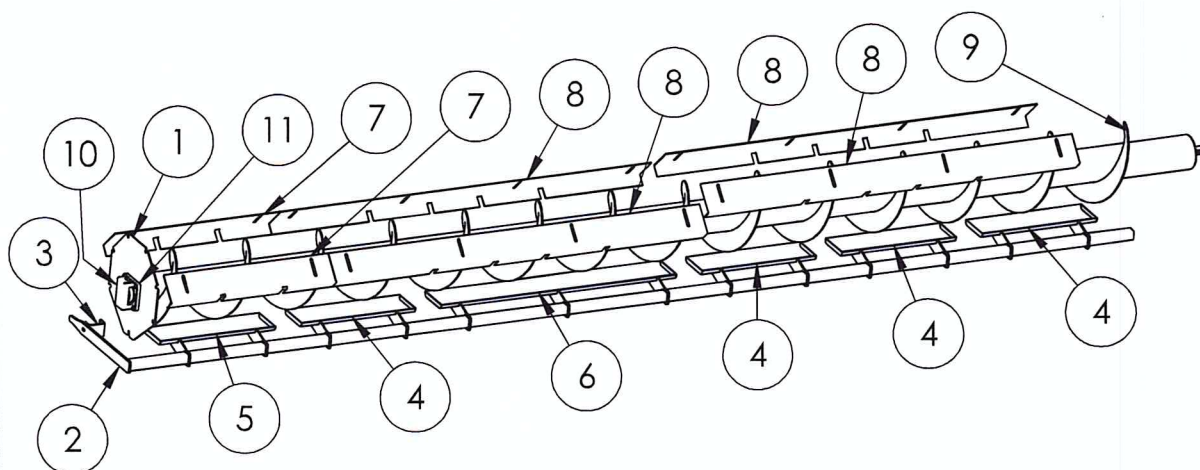

ITEM NO.	PART NUMBER	DESCRIPTION	18T QTY	25T QTY
1	0205007	END PLATE	1	1
2	0205023 0205026	18T GATE HANDLE 25T GATE HANDLE	1	1
3	0205023-03	GATE BRACKET	1	1
4	0205022 0205027	18T FRONT GATE 25T FRONT GATE	2 -	- 5
5	0205025	18T REAR GATE	1	-
6	0205024 0205028	18T CENTRE GATE 25T CENTRE GATE	1 -	- 1
7	0205029-LH	25T REAR CUTOFF PLATE		2
8	0205041-LH 0205030-LH	18T CUTOFF PLATE 25T FRONT CUTOFF PLATE	6 -	- 4
9	0207042 0207041 0207006	18T CROSS AUGER - 15" 18T CROSS AUGER - 20" 25T CROSS AUGER	1 1 opt -	- - 1
10	0207050	BEARING CAP	1	1
11	2601002	BEARING - UCF210	1	1

Issue:

30T & 35T CROSS AUGER ASSEMBLY

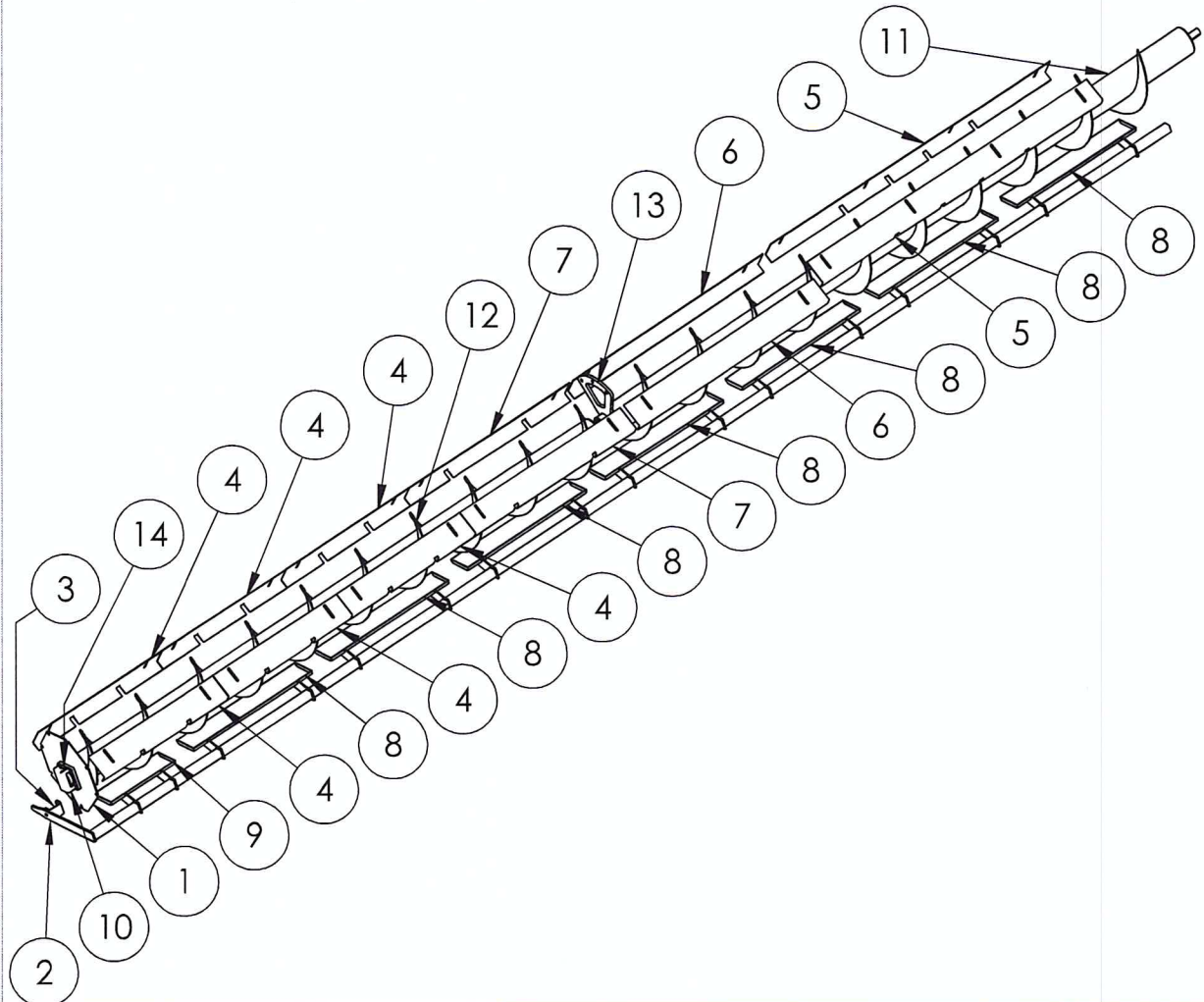

ITEM NO.	PART NUMBER	DESCRIPTION	30T QTY.	35T QTY.
1	0205007	END PLATE	1	1
2	0205044	GATE HANDLE	1	1
3	0205023-03	GATE HANDLE BRACKET	1	1
4	0205029-LH	REAR CUTOFF PLATE	2	6
5	0205030-LH	FRONT CUTOFF PLATE	4	2
6	0205040-LH	FRONT CENTRE CUTOFF PLATE	-	2
7	0205041-LH	REAR CENTRE CUTOFF PLATE	2	2
8	0205042	LONG GATE	6	7
9	0205047	30T SHORT GATE	1	-
	0205043	35T SHORT GATE	-	1
10	0207050	BEARING COVER	1	1
11	0207066	FRONT AUGER	1	1
12	0207069	30T REAR AUGER	1	-
	0207067	35T REAR AUGER	-	1
13	0207068	CENTRE BEARING	1	1
14	2601002	BEARING – UCF210	1	1

Issue:

PTO COUPLING ASSEMBLY

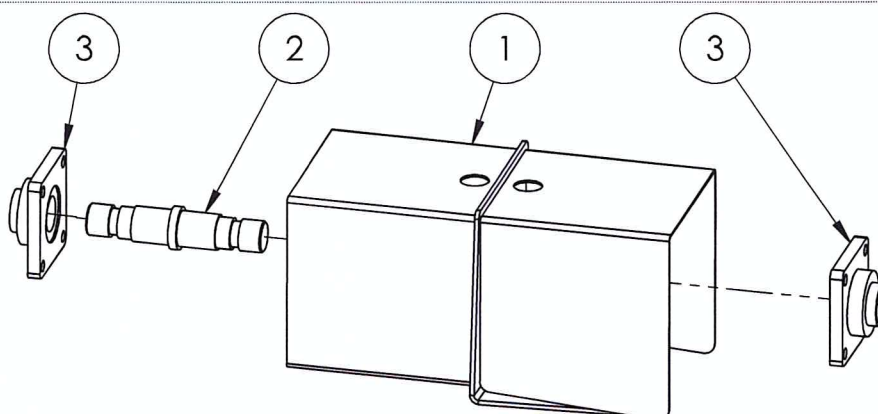

ITEM NO.	PART NUMBER	DESCRIPTION	QTY.
1	0207017	PTO GUARD	1
2	0207018	PTO SHAFT	1
3	2601002	BEARING – UCF210	2

SINGLE AXLE ASSEMBLY

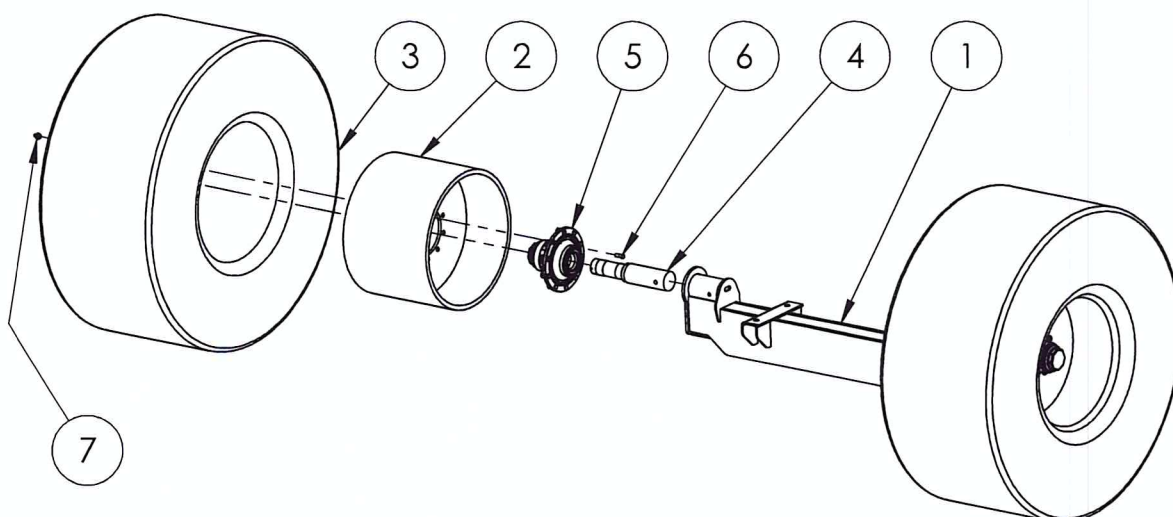

ITEM NO.	PART NUMBER	DESCRIPTION	QTY.
1	0204001	18T & 25T STANDARD AXLE	1
	0204006	18T & 25T 3 METRE AXLE	
	0204023	30T STANDARD AXLE	
	0204024	30T 3 METRE AXLE	
2	-	RIM	2
3	-	TYRE	2
4	2203006-01	STANDARD STUB AXLE	2
	25001	LOAD CELL STUB AXLE	
	2203007-01	30T STUB AXLE	
5	2203006-03	STANDARD HUB	2
	2203007-03	30T HUB	
6	2203006-04	STANDARD STUD	20
	2203007-04	30T STUD	24
7	2203006-05	STANDARD WHEEL NUT	20
	2203007-05	30T WHEEL NUT	24

Issue:

BOGIE AXLE ASSEMBLY

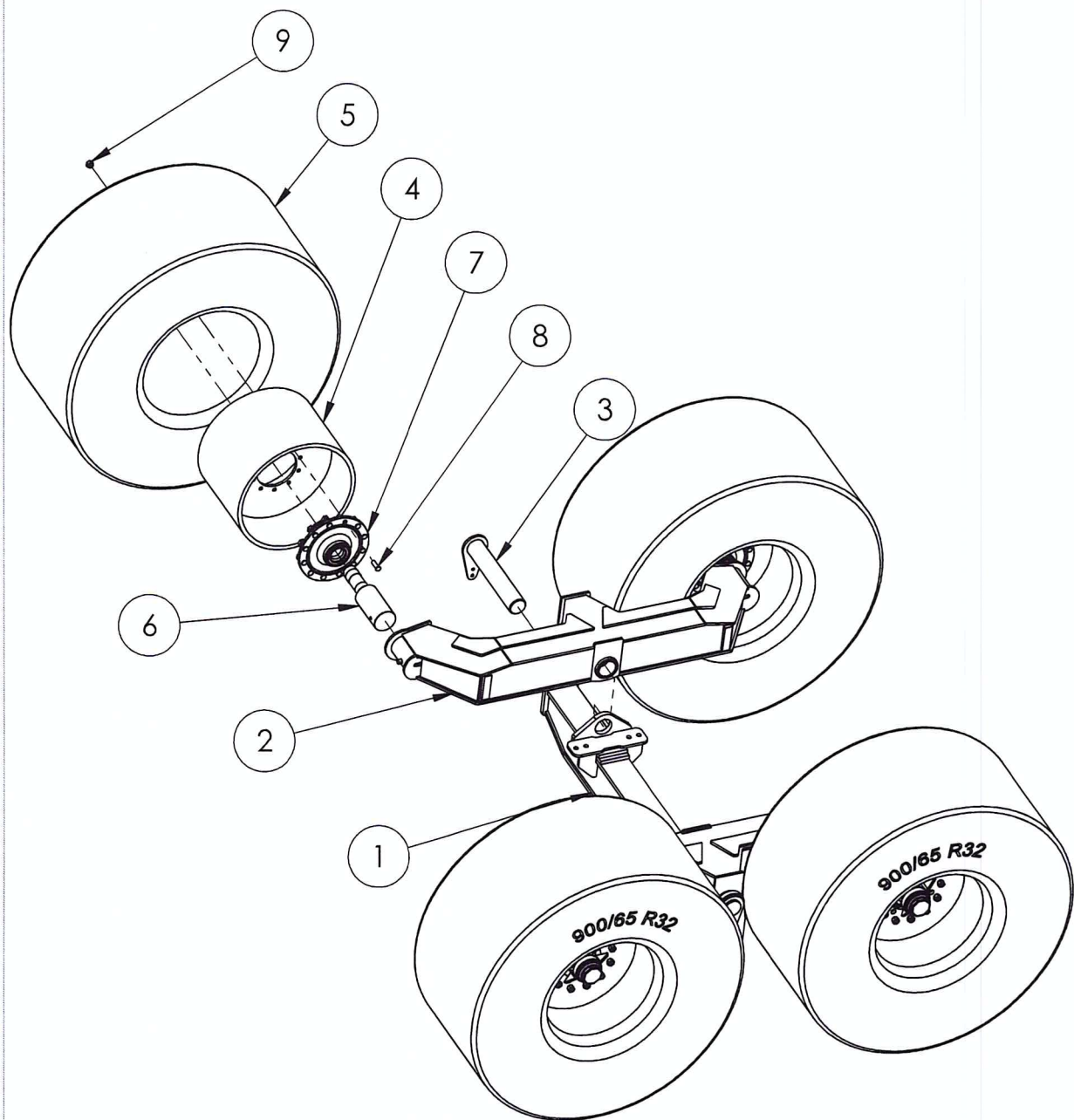

ITEM NO.	PART NUMBER	DESCRIPTION	QTY.
1	0204015	AXLE BEAM	1
2	0204016	WALKING BEAM	2
3	0204017	WALKING BEAM PIN	2
4	-	RIM	4
5	-	TYRE	4
6	2203007	AXLE	4
7	2203007-02	HUB	4
8	2203007-04	STUD	48
9	2203007-05	WHEEL NUT	48

Issue:

TARP ASSEMBLY

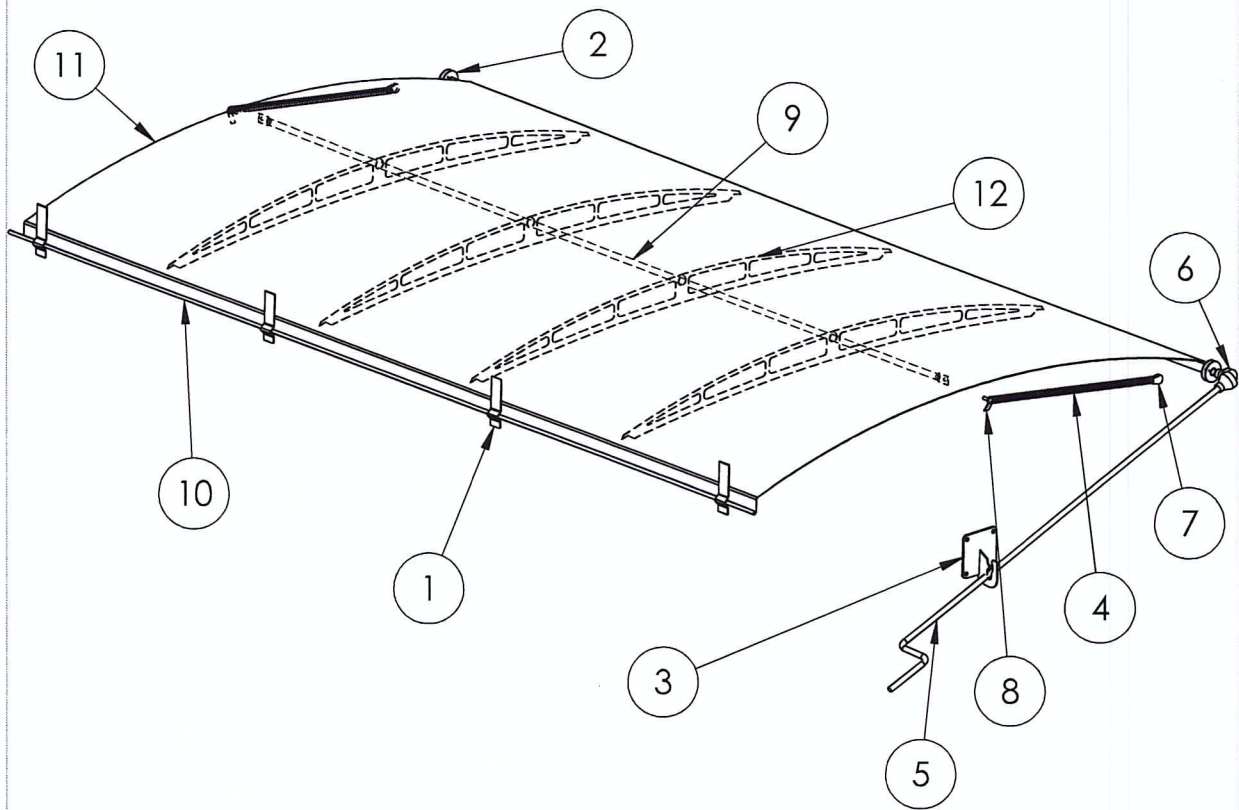

ITEM NO.	PART NUMBER	DESCRIPTION	QTY.
1	0205038	TARP CATCHER	4
2	0220019-18 0220019-25 0220019-30 0220019-35	TARP WINDER - 18T TARP WINDER - 25T TARP WINDER - 30T TARP WINDER - 35T	1
3	0220023	TARP HANDLE HOOK	1
4	0220024	TARP SPRING	2
5	0220025	TARP HANDLE	1
6	0220026	UNIVERSAL JOINT	1
7	0220028	PULLEY	2
8	0220029	SPRING RETAINER	2
9	0205009	CENTRE ROD	1
10	0220027	RETAINING ROD	1
11	0220030	TARP	1
12	0205008	TARP BOW	4

Issue:

OPTIONAL AUGER ATTACHMENTS

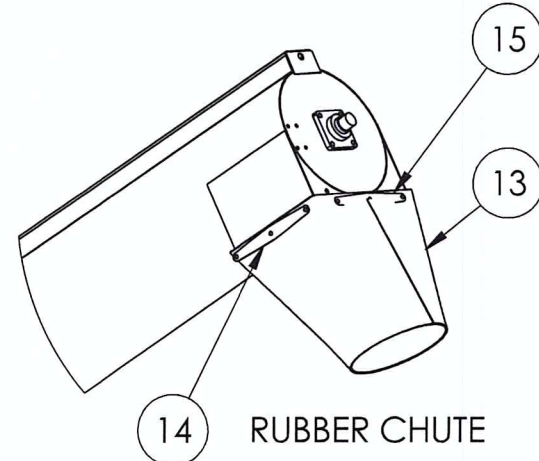
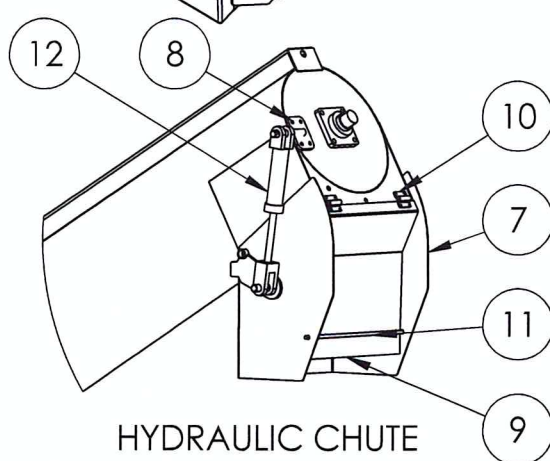
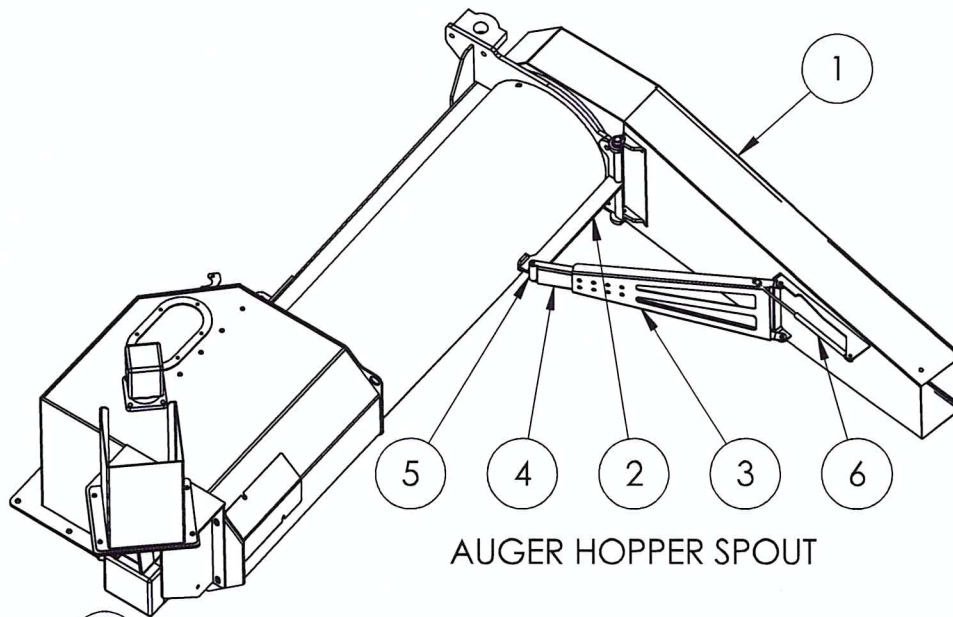

ITEM NO.	PART NUMBER	DESCRIPTION	QTY.
1	0220012	HOPPER SPOUT - 15"	1
	0220001	HOPPER SPOUT - 20"	
2	0220001-BKT	SPOUT MOUNTING BRACKET	1
3	0220011-01	OUTER STAY ARM	1
4	0220011-03	INNER STAY ARM	1
5	0220011-04	PLASTIC BUSH	1
6	2505001	GAS STRUT	1
7	0220006	HYDRAULIC CHUTE - 15"	1
	0220008	HYDRAULIC CHUTE - 20"	
8	0220007	CYLINDER LUG	1
9	0220006-03	HYDRAULIC DEFLECTOR - 15"	1
	0220008-03	HYDRAULIC DEFLECTOR - 20"	
10	2501001-01	HINGE - BUTT	2
11	0220006-08	HYDRAULIC BAR - 15"	1
	0220008-08	HYDRAULIC BAR - 20"	
12	2101002	HYDRAULIC CYLINDER	1
13	0207056	RUBBER CHUTE - 15"	1
	0207055	RUBBER CHUTE - 20"	
14	0207054	RUBBER RETAINER	2
15	0207057	RUBBER RETAINER - 15"	2
	0207054	RUBBER RETAINER - 20"	

OPTIONAL TRANSPORT LIGHTING

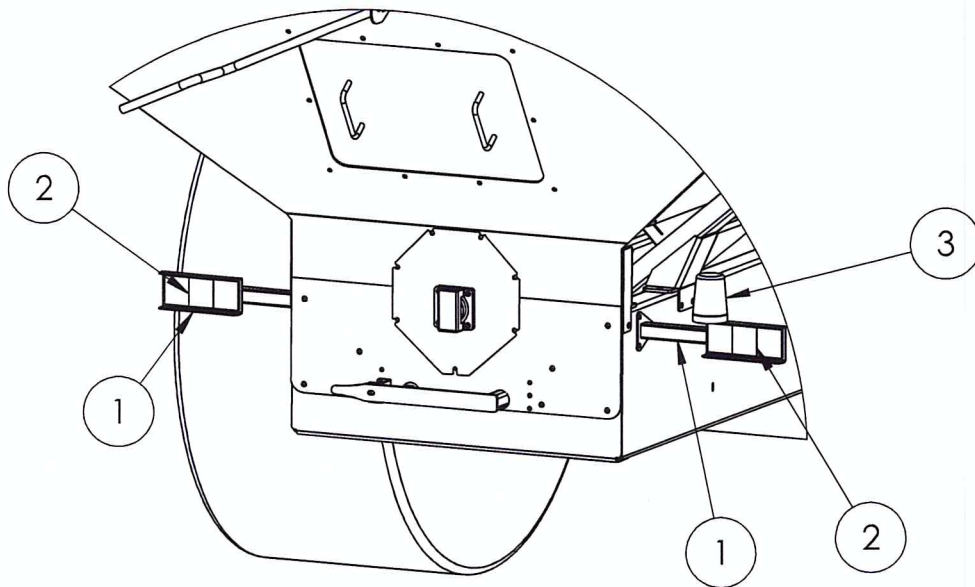

ITEM NO.	PART NUMBER	DESCRIPTION	QTY.
1	0220003	LIGHT BRACKET	1
2	23-001	TAIL LIGHTS	2
3	23-002	ROTATING BEACON	1

OPTIONAL HYDRAULIC DRIVE - 15" ONLY

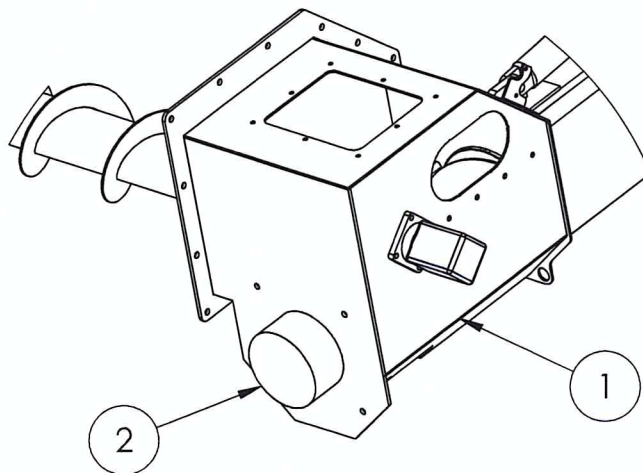

ITEM NO.	PART NUMBER	DESCRIPTION	QTY.
1	0207030	LOWER AUGER ASSEMBLY	1
2	2102001	HYDRAULIC MOTOR	1

Issue: